

Installation Instructions

503029 Posilok™ Safety Belt by Draper

Before You Begin

- ① Does the location you wish to place the Posilok have enough room for adaptors, mounting hardware, and servicing of the unit?
- ② Is the pipe, flange or wall to which you wish to attach the Posilok structurally adequate (consult your engineer for approval)?
- ③ Fleet angles up to 45 degrees are acceptable as shown in Fig. 1. Lateral angles for the strap are not acceptable, and the strap must run clear without touching the edges of the slot, or any other obstacle.

These instructions are meant as a guide only. They do not imply any responsibility on the part of Draper, Inc. for improper installation or faulty workmanship at the job site.

Before installing, make sure the device is working. Pull quickly on the strap. You should hear an audible click as it locks. If the device does not function properly, contact your dealer or Draper.

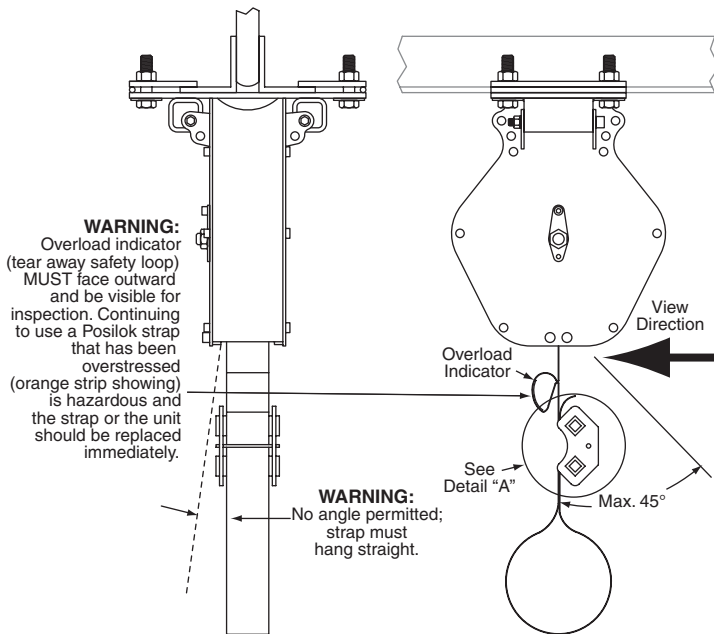

Figure 1

For Tube Mounts

Pipe clamp hex bolts have a retaining ring for your convenience. The Posilok and clamp can be held by one hand while the bolts are hand tightened with the other. The cross-threaded cylinder needs no nut.

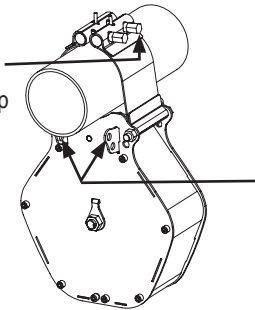
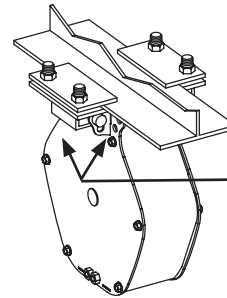

Figure 2

Perpendicular mount shown. For parallel mount, attach brackets to sides of Posilok, using these mounting lugs. Use the lower holes for small pipe (3½" diameter), and use the upper holes for large pipe (4" diameter).

For Beam Mounts



Parallel mount shown. For perpendicular mount, attach brackets to sides of Posilok, using these mounting lugs.

Figure 2

For Wall Mounts

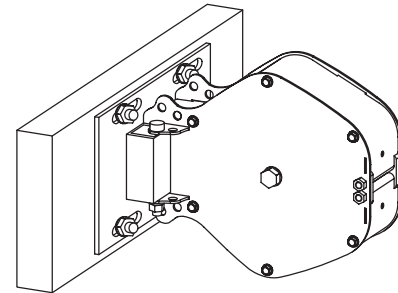

Figure 3

Warning:
No sheave, pulley or turning device may be used to turn the Posilok belt. Failure of the pulley will lead to catastrophic failure of the safety system.

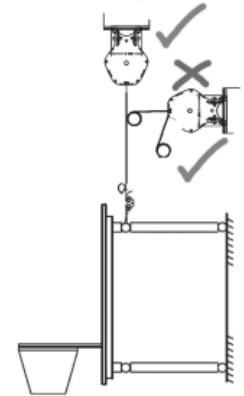

Figure 4

A note on torquing fasteners:

Torquing of all fasteners should be done after hand tightening, with a proper torque wrench calibrated in inch-pounds or foot-pounds. Metric torque wrenches can be used, provided you make the proper Imperial to Metric conversion. See page 2 for torque chart.

Posilok Torque Chart

Description	Quantity	Foot-Pounds	Inch-Pounds
Beam Clamp Bolts	4	20	240
Beam Clamp Adaptor Bolts	4	40	480
Pipe Clamp Hinge Bolts	4	10	120
Pipe Clamp Hex Bolts	4	20	240

DRAPER

(Continued on page 2)

Stem Attachment

- ① Attach lower safety belt clamp to main stem according to project drawings or backstop type (see Fig. 5-7 below).

Please Note: A breakaway loop is stitched to indicate if the unit has been subjected to a heavy load. A bright colored warning label will be exposed if the loop stitching has been broken. DO NOT use the loop as an attachment point.

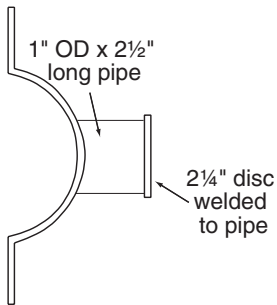

Figure 5

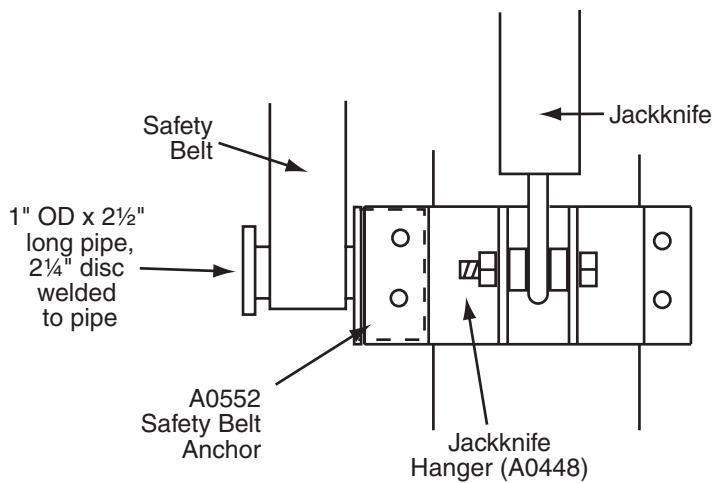

Figure 6

A0552 Safety Belt Clamp

Please Note: Use A0552 when Posilok safety belt is mounted next to the upper jackknife hanger (typically A0451). A0552 mounts inside jackknife hanger using same cap screws that are used to fasten the jackknife clamp.

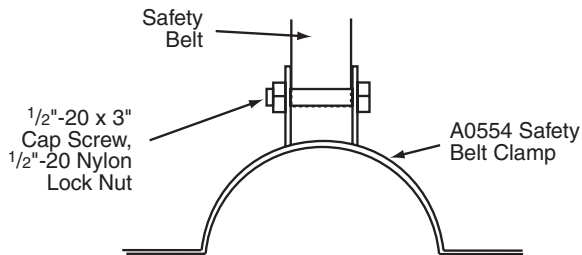

Figure 6

A0554 Safety Belt Clamp (top view)

Please Note: Use A0554 when Posilok safety belt is mounted behind the upper jackknife hanger (typically A0451). Attach to stem using a 6 inch x 2 inch Half Clamp, two 1/2 inch-20 x 2 1/2 inch cap screws, and hex nuts.

Safety Belt Tie-Off

- ① Lay the free end returning from the tie-off point against the strap coming out of the Posilok.

Please Note: The side with the free end is UP.

- ② Place the clamp on the strap with the cotter pin in the up position.
- ③ Remove cotter pin and bar from the clamp.
- ④ Pull the overlapped strap up through the hole left when the bar was removed.
- ⑤ Slide the bar under the strap loop.
- ⑥ Cinch the strap tight until it traps the bar into the clamp again.
- ⑦ Replace cotter pin and secure.

Please Note: Loop sewn in belt is designed to tear away if the Posilok is tripped. LOOP SHOULD NOT BE USED AS AN ANCHOR POINT!

Please Note: For DUW backstops, attach safety belt to upper bank hanger.

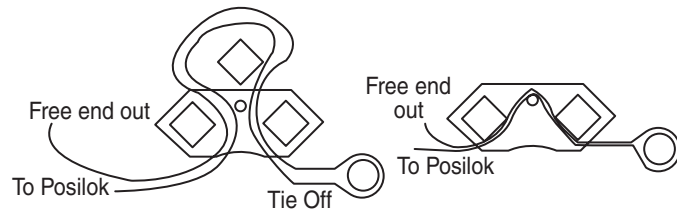

Figure 8

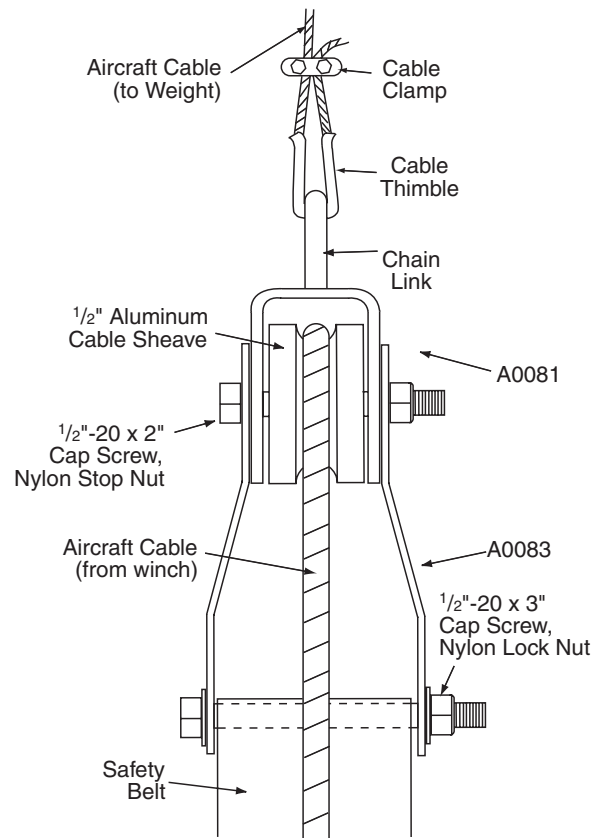

Figure 9

A0081 Small Block Cable Guide with A0083 Safety Belt Retractor (for use with TF-20J/TF-20J-B only)